



**MAXIMISED INTERNAL
CAPACITY AND TWO-
HOUR CERTIFIED FIRE
PROTECTION**



DATAGUARD NT

FIRE-RESISTANT DATA MEDIA PROTECTION



NT Fire 017
120 Diskette

KEY FEATURES

- Certified NT Fire 017 – 120 Diskette for two-hour protection of data media from fire.
- Single-door safe with no insert required – means internal capacity is maximised and up to 60% more storage space than other safes in the same class.
- User-friendly, slam-action door. When shut, provides full fire protection without needing to be locked.
- Adjustable shelving and drawer units supplied as standard.
- Available in four sizes, ranging from 30–128 litres.
- Choice of key or electronic locking.

DATAGUARD NT

PRODUCT SPECIFICATIONS

Model	EXTERNAL (mm)			INTERNAL (mm)			FITTINGS			
	Height*	Width	Depth*	Height**	Width**	Depth	Volume (litres)	Weight (kg)	Shelf	Extendable Drawer
25	530	546	566	280	346	306	30	145	1	0
40	700	546	566	450	346	306	48	190	1	1
80	1025	546	590	775	346	330	89	263	1	2
120	1025	702	590	775	502	330	128	330	1	2

*External heights and depths include plinth and handle projection. **Internal heights and widths are also equal to the clear opening measurements.

CAPACITY OVERVIEW

Media designation	Dimension (mm)	MODEL									
		25		40		80		120			
		No. of drawers*	Total capacity	No. of drawers*	Total capacity	No. of drawers*	Total capacity	No. of drawers*	Total capacity		
AIT Data Cartridge (Sony)	Magnetic	67 x 21 x 112	2	56	3	56	6	60	6	88	
DAT Cassettes	Magnetic	80 x 15 x 60	4	63	6	63	10	66	10	101	
Data Cartridges 3.5"	Magnetic	96 x 12 x 100	2	66	4	66	7	72	7	111	
Data Cartridges 5.25"	Magnetic	141 x 17 x 159	1	32	2	32	4	34	4	53	
DDS 8 mm (DC 8)	Magnetic	102 x 20 x 68	3	34	5	34	9	36	9	58	
DDS 4 mm (DC 4)	Magnetic	80 x 16 x 58	4	60	6	60	10	63	10	96	
DLT – tapes	Magnetic	110 x 30 x 112	2	22	3	22	6	22	6	36	
IBM 3480 / 3490	Magnetic	127 x 25 x 110	2	24	3	24	6	24	6	37	
LTO tapes	Magnetic	110 x 30 x 112	2	22	3	22	6	22	6	36	
On Stream ADR (Verbatim)	Magnetic	129 x 15 x 95	2	40	4	40	7	42	7	65	
PD Cartridge (Fuji)	Magnetic	135 x 8 x 124	2	74	3	74	5	80	5	121	
SLR / MLR 5.25" (Imation)	Magnetic	116 x 21 x 161	1	32	2	32	4	34	4	50	
Travan Data Cartridge (Sony)	Magnetic	78 x 19 x 100	2	51	4	51	7	60	7	81	
CD / DVD (R, RW and RAM)	Optical	142 x 10 x 124	2	55	3	55	5	60	5	91	
MO - R/W (magneto-optical disc)	Optical	157 x 16 x 143	1	25	2	25	4	26	4	34	
Optical Disc 3.5"	Optical	94 x 6 x 90	2	139	4	139	7	153	7	229	
Optical Disc 5.25"	Optical	135 x 11 x 153	1	54	2	54	4	54	4	89	
ZIP Disk Media	Optical	103 x 12 x 104	2	58	4	58	7	62	7	100	

*Using pull out drawers for best access; capacities can be higher if shelves are used and media is stacked like bricks.

LOCK OPTIONS

All models can be fitted with either a key lock or an electronic lock. The electronic lock has a programmable six digit code which can be set by the user.

INTERNAL FITTINGS

A shelf and extendable drawer(s) accompany each safe as standard (see Product Specifications above). These can be adjusted using the safe's internal ladder racking system. Additional shelves and drawers can be supplied on request.

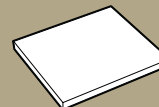

Adjustable shelf

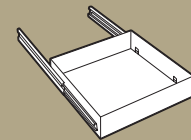

Extendable drawer

Authorised dealer

www.chubbsafes.com